

6.0m setback line from rear boundary

2.0m setback line from side boundary

BOUNDARY

BOUNDARY

- Note:
- All exterior timber framed walls plus the central wall of the sleeping block are ex150x50 with studs at 450c/s.
 - Exterior plywood claddings are to be installed over 45x20 battens on building paper to form a drained cavity.
 - Blockwork walls are to be plastered with a colour added, waterproof system. Apply plaster to all exterior surfaces plus exposed interior areas on level 1.

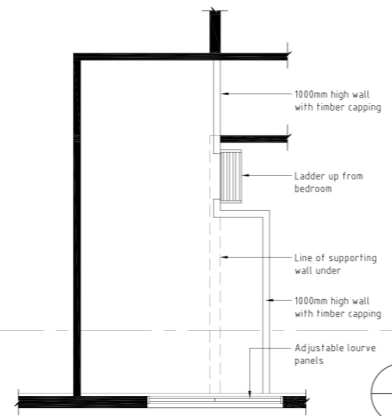

1 LEVEL ONE PLAN
1:50 @ A1, 1:100 @ A3

2 MEZZANINE PLAN
1:50 @ A1, 1:100 @ A3